

DESCRIPTION: PP RADIAL CORROSIVE ENVIRONMENT FAN

IT CONTAINS RAW MATERIALS AND ADDITIVES ACCORDING TO THE AREA OF USE.

No	PART NAME	DEFINITION	AMOUNT	MATERIAL	EXPLANATIONS
1	MK 35 80	MOTOR MOUNTING BRACKET	1	ST37 / AISI 304	
2	RG 35R	RADIAL FAN HOUSING	1	PE / PE-el	
3	GK 35	BODY COVER	1	PP / PPS-el	
4	KC 35	COVER GASKET	1	ELASTOMER	
5	MKS 35	MOTOR CONSOLE COVER	1	ST37 / AISI 304	
6	Motor	ELECTRIC MOTOR	1		
7	HB B2	HUB COVER	1	PP / PPS-el	
8	RP 35R /19	IMPELLER	1	PP / PPS-el	
9	TH2	DRAIN HOSE	1	PP	
10	Z2	VIBRATION INSULATOR	4	RUBBER	
11	M6-bolt nut	M6- BOLT NUT	4	A4	
12	M6x16 Flanged Bolt	MOTOR PROTECTION CAP BOLT	4	A4	
13	M8-Flanged nut	M8 FLANGED NUT	8	A4	
14	M8x20-Flanged Bolt		8	A4	
15	M8x25 Flanged Bolt		4	A4	
16	M8 insert	Messing (insert)	8	BRASS	
17	M6x35 Flanged Bolt	IMPELLER MOUNTING BOLT	1	A4	
18	DIN EN 24018 - M8 x 20-WS	DRAIN REPLACEMENT PLUG	1	BRASS	

TECHNICAL SPECIFICATIONS	
FLOW	m3/h
PRESSURE	Ptot (Pa)
ENGINE POWER	Kw
ENGINE SPEED	Rpm
FAN SERIAL NO.	
ENGINE SERIAL NO.	
DRAWING	A.Asik
INSPECTOR	A.Kutlu
CONFIRMATION	G.Eracun
QUALITY	A.Topcuoglu

RSD P 35B/

CUSTOMER

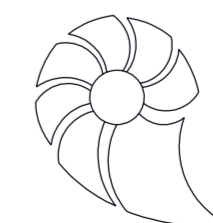

Gurvent Ventilatoren GmbH
 Alemannenstraße. 7, 77971
 Kippenheim Deutschland
 www.gurventventilatoren.de

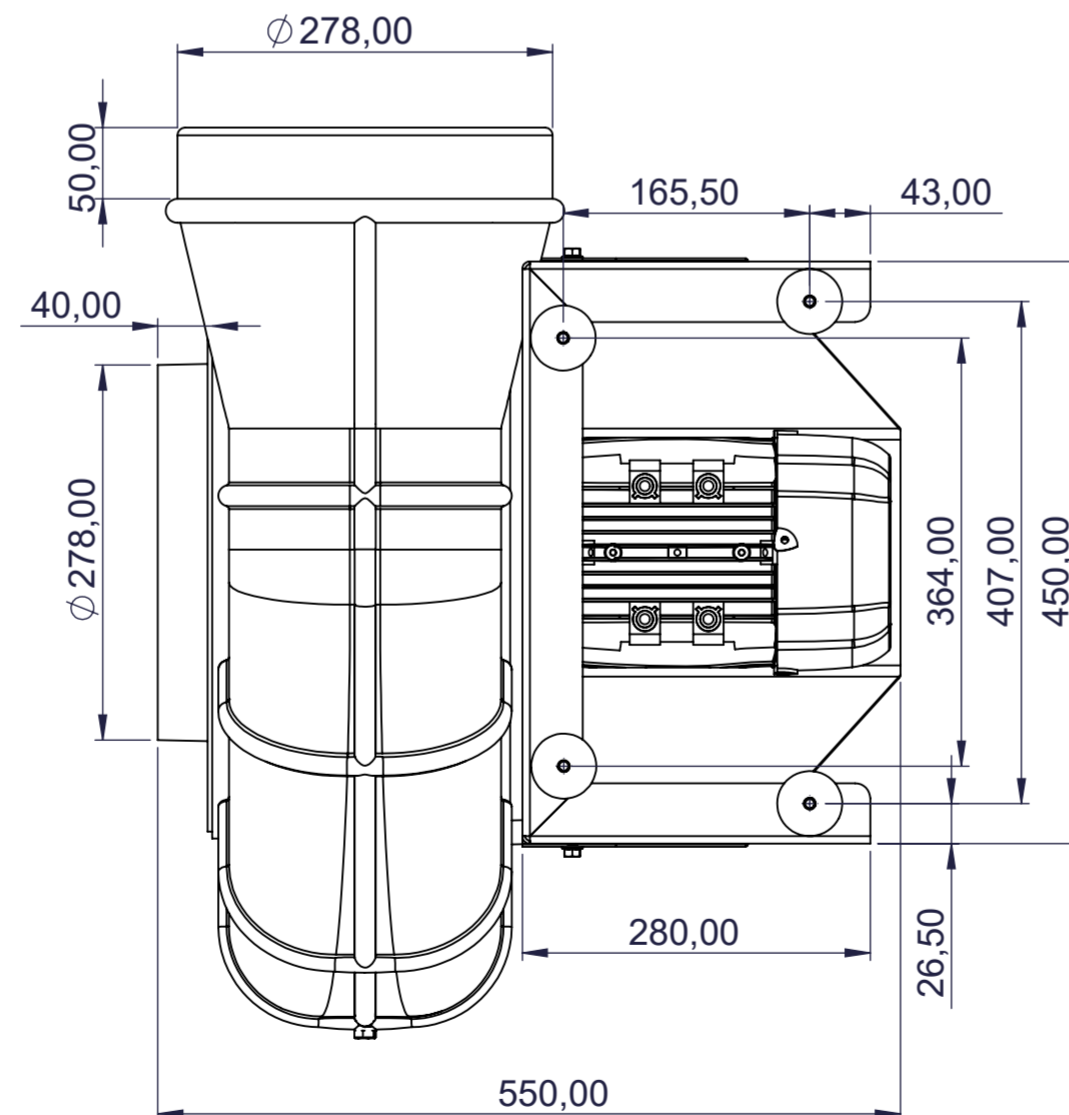
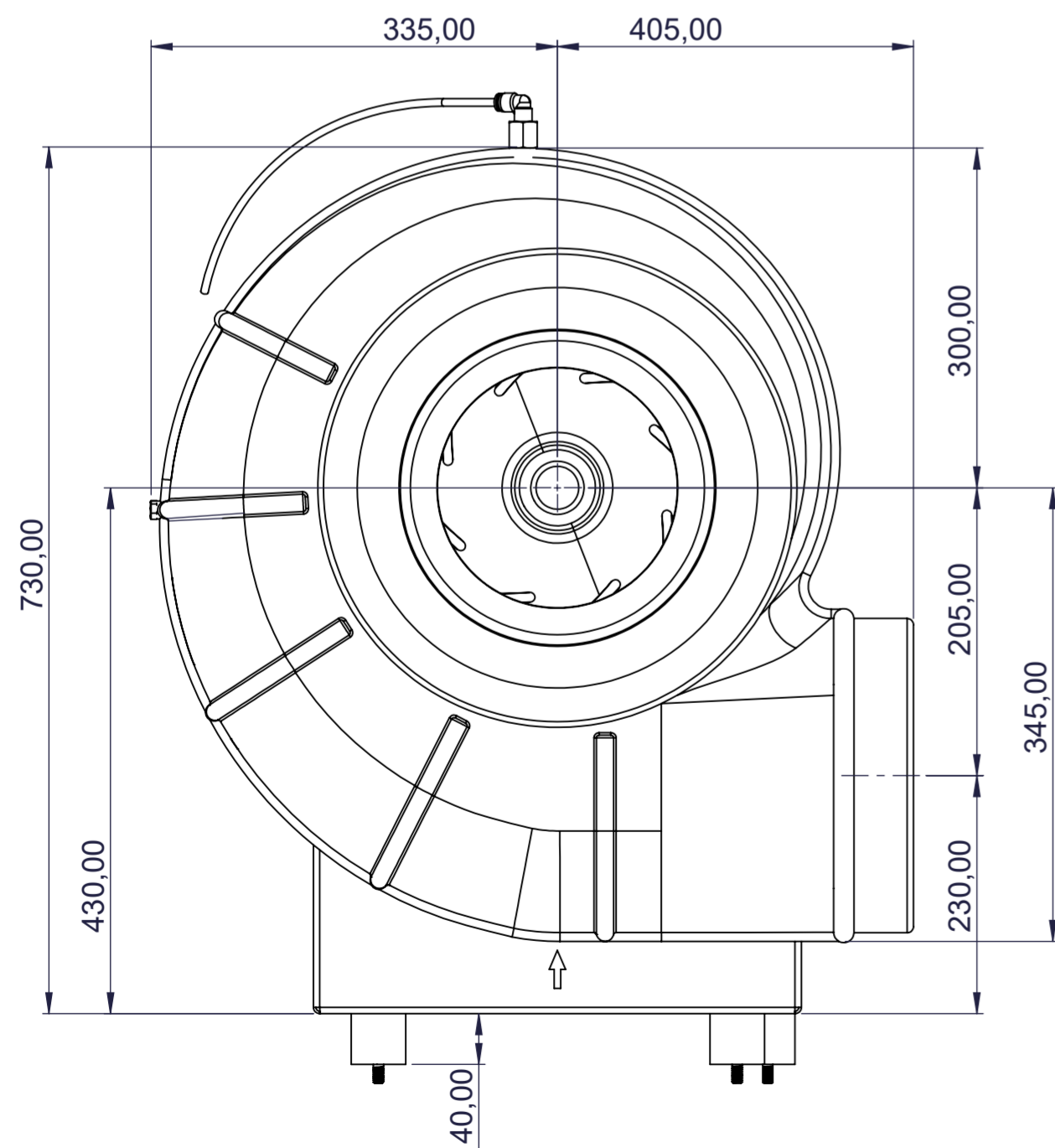

CASE DIMENSIONS	WIDTH	LENGHT	HEIGHT	WEIGHT
K35	785	600	875	