

DE : Die RSDP-Serie Radialventilatoren ist speziell für die Belüftung von sauren und korrosiven Umgebungen ausgelegt. Sie ist die ideale Lösung, wenn abrasive Gase, verunreinigte Luft oder andere aggressive Bestandteile Teil der Abluft sind. Typische Anwendungen: Galvanikanlagen, medizinische Einrichtungen, Lebensmittelindustrie, Elektroindustrie, petrochemische Anlagen. Laufrad : Hergestellt aus PP, PPS, PP-el und PA Materialien Rückwärtsgekrümmte Aerofoil-3D-Schaufelgeometrie, hoher Wirkungsgrad und geräuscharmer Betrieb, statisch und dynamisch ausgewuchtet gemäß ISO 1940-1 G6.3 Gehäuse: Hergestellt aus PE, PE-el, PP, PPS und PP-el Materialien, hohe Beständigkeit gegen Korrosion und UV-Strahlung, integrierter Ablaufschlauch und Ablassventil. Tragkonsole: Feuerverzinkter Stahl, Befestigungselemente: A4 / AISI 316 Edelstahl Betriebsbedingungen: Lufttemperatur: -15°C bis +70°C, Motorposition: außerhalb des Luftstroms, Schutzart: IP55, Motortyp: vollständig gekapselt, hocheffizient, wartungsfreundlich

ATEX Version : Alle ATEX-zertifizierten Explosionsgeschützten Modelle sind hergestellt aus: Antistatischen Materialien, flammhemmenden Materialien Hauptvorteile : Hoher Wirkungsgrad und niedriger Geräuschpegel, hervorragende Korrosionsbeständigkeit, lange Lebensdauer, einfache Wartung, geeignet für aggressive Umgebungen

EN : The RSDP series centrifugal fans are specifically designed for the ventilation of acidic and corrosive environments. They are the ideal solution when Abrasive gases, contaminated air, or other aggressive components are present in the exhaust air. Typical applications: Plating plants, Medical facilities, Food industry, Electrical industry, Petrochemical plants. Impeller : Manufactured from PP, PPS, PP-el, and PA materials Backward-curved aerofoil 3D blade design, High efficiency and low noise operation, Statically and dynamically balanced according to ISO 1940-1 G6.3 Casing : Made of PE, PE-el, PP, PPS, and PP-el materials, High resistance to corrosion and UV radiation, integrated drain hose and drain valve. Motor Support bracket: Hot-dip galvanized steel, Fasteners: A4 / AISI 316 stainless steel. Operating Conditions : Air temperatures: -15°C to +70°C , Motor position: Outside the airflow, Protection class: IP55, Motor type: Totally enclosed, high-efficiency, easy maintenance

ATEX Version : All ATEX-certified explosion-proof models are manufactured from: Antistatic materials, Flame-retardant materials. Key Advantages : High efficiency and low noise, Excellent corrosion resistance, Long service life, Easy maintenance, Suitable for aggressive environments



ATEX VERSION



STANDART VERSION

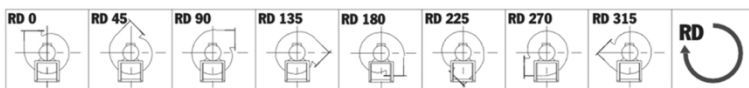
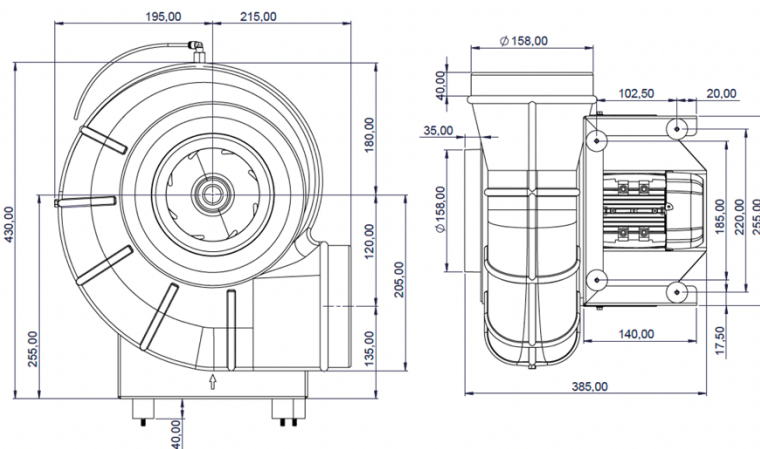

| Type | Bestellnummer | Supply | Air Flow | Speed | Motor | Current | Temp. | Weight |
|---------------------------------------|---------------|--|-------------------|---|-------|---------|-------|--------|
| | Order Number | V | m ³ /h | min ⁻¹ | Kw | Amp | +°C | Kg |
| RSDP 18B/2/50.T | ⑧ 1182501 | 400V/50Hz | 800 | 2950 | 0,37 | 0,97 | 70 | 11 |
| RSDP 18B/4/50.T | ③ 1184501 | 400V/50Hz | 400 | 1450 | 0,37 | 0,97 | 70 | 11 |
| RSDP 18B/2/50.M | ⑧ 1182502 | 230V/50Hz | 800 | 2950 | 0,37 | 2,50 | 70 | 11 |
| RSDP 18B/4/50.M | ③ 1184502 | 230V/50Hz | 400 | 1450 | 0,37 | 2,50 | 70 | 11 |
| RSDP 18B/6/50.T | ① 1186501 | 400V/50Hz | 250 | 950 | 0,18 | 1,20 | 70 | 11 |
| Explosion proof / ATEX Version | | >> Gas / Ex II 2G h T4-T6 IP65 - (Gas) - Zone1/2 | | >>Dust / Ex II 2D tb IIIC T135° Db (IP65) – Zone1/2 | | | | |
| RSDP 18B/2/50.Ex | ⑧ 1182503 | 400V/50Hz | 800 | 2950 | 0,37 | 0,97 | 70 | 11 |
| RSDP 18B/4/50.Ex | ③ 1184503 | 400V/50Hz | 400 | 1450 | 0,37 | 0,97 | 70 | 11 |
| RSDP 18B/2/50.Ex M | ⑧ 1182504 | 230V/50Hz | 800 | 2950 | 0,37 | 2,50 | 70 | 11 |
| RSDP 18B/4/50.Ex.M | ③ 1184504 | 230V/50Hz | 400 | 1450 | 0,37 | 2,50 | 70 | 11 |
| RSDP 18B/6/50.Ex | ① 1186503 | 400V/50Hz | 250 | 950 | 0,18 | 1,20 | 70 | 11 |

Atex Notification Certificat Number : IEP 22 ATEX N 406
 CE Type Examination Number : IEP 16 ATEX 0402X
 Product Quality Assurance Notification : IEP 25 ATEX Q1643
Modified Body Number : 2284
 ATEX 2014/34/EU - EN 14986 : 2007
 EN 60079-0 : 2012 - EN 13463-1 : 2011
ZONE1 - ZONE 2



Management System
ISO 9001:2015
 ID : 01 100 902038
 www.tuv.com

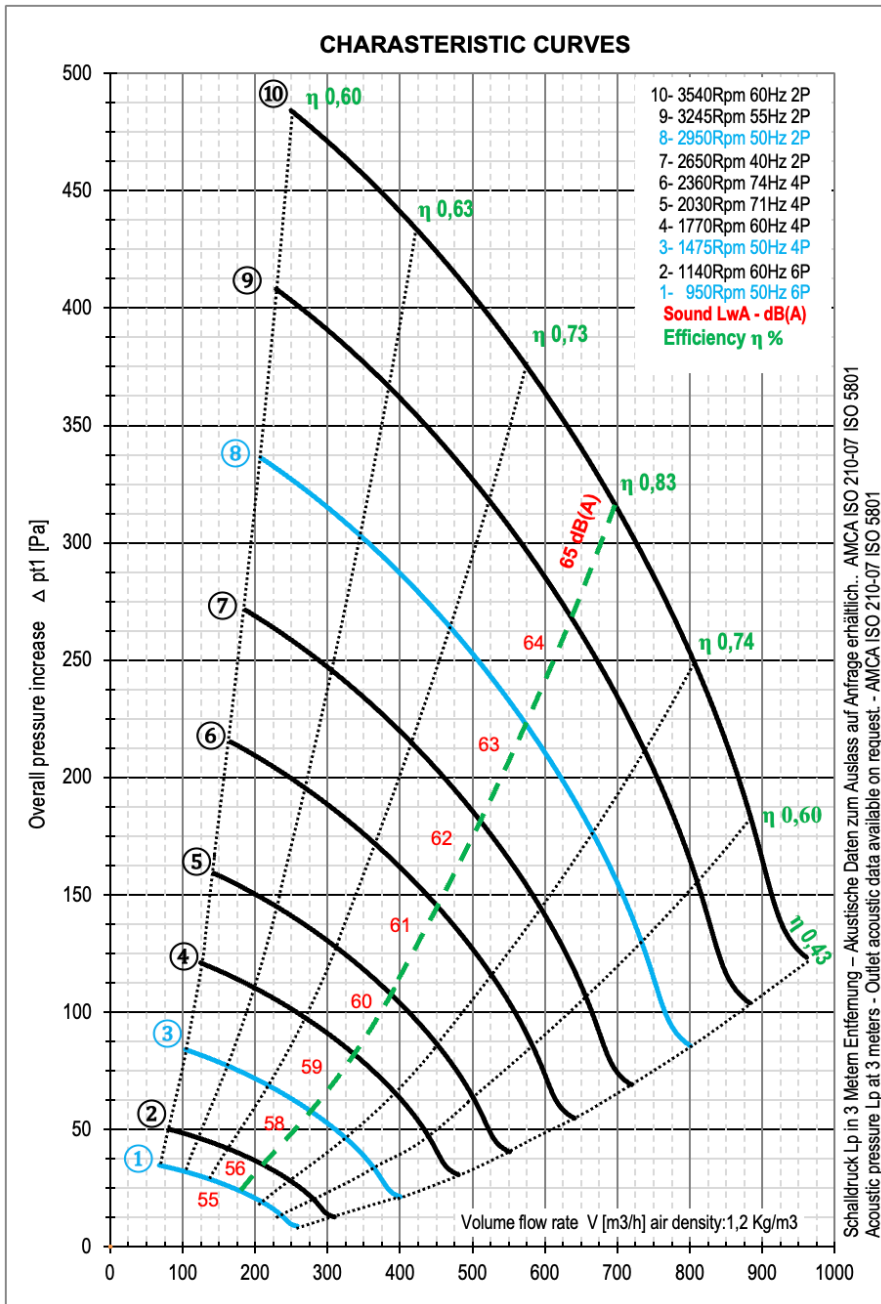

New reinforced backward curved Aerofoil impeller

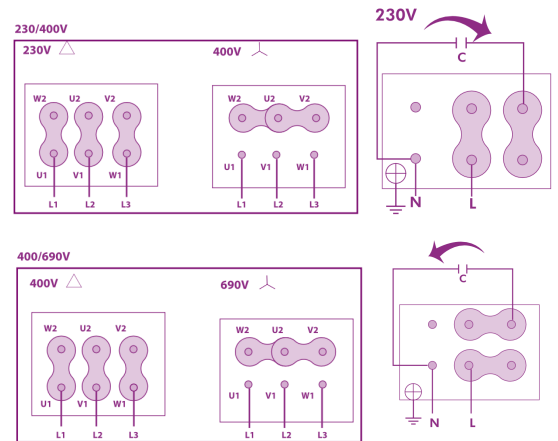

| Model | Speed Rpm | Frequency Hz | Power Kw | Sound dB(A) | Total Pressure Δp_t (Pa) / Volume Flow Rate (m ³ /h) | | | | | | | | | | | | | |
|-----------------|--------------|-----------------|-------------|----------------|---|-----|-----|-----|-----|-----|-----|-----|-----|-----|-----|-----|-----|--|
| | | | | | 10 | 20 | 30 | 40 | 50 | 60 | 70 | 80 | 90 | 100 | 115 | 130 | 150 | |
| RSDP 18B/6/50.. | ① 950 | 50Hz | 0,18 | 55 | 250 | 200 | 180 | 150 | | | | | | | | | | |
| RSDP 18B/6/60.. | ② 1140 | 60Hz | 0,18 | 56 | 300 | 280 | 250 | 200 | 100 | | | | | | | | | |
| RSDP 18B/4/50.. | ③ 1450 | 50Hz | 0,37 | 58 | 400 | 380 | 350 | 300 | 285 | 250 | 150 | 100 | | | | | | |
| RSDP 18B/4/60.. | ④ 1770 | 60Hz | 0,37 | 59 | | 480 | 450 | 425 | 400 | 375 | 350 | 315 | 260 | 210 | 190 | | | |
| RSDP 18B/4/71.. | ⑤ 2030 | 71Hz | 0,37 | 60 | | | 550 | 540 | 525 | 500 | 460 | 430 | 400 | 380 | 350 | 200 | | |

| Model | Speed Rpm | Frequency Hz | Power Kw | Sound dB(A) | Total Pressure Δp_t (Pa) / Volume Flow Rate (m ³ /h) | | | | | | | | | | | | | |
|-----------------|--------------|-----------------|-------------|----------------|---|-----|-----|-----|-----|-----|-----|-----|-----|-----|-----|-----|-----|--|
| | | | | | 75 | 100 | 125 | 150 | 175 | 200 | 250 | 275 | 300 | 325 | 350 | 400 | 450 | |
| RSDP 18B/4/74.. | ⑥ 2350 | 74Hz | 0,37 | 61 | 600 | 550 | 500 | 450 | 375 | 250 | | | | | | | | |
| RSDP 18B/2/40.. | ⑦ 2650 | 40Hz | 0,37 | 62 | 700 | 680 | 650 | 580 | 500 | 450 | 300 | | | | | | | |
| RSDP 18B/2/50.. | ⑧ 2950 | 50Hz | 0,37 | 63 | 800 | 750 | 730 | 700 | 650 | 625 | 500 | 450 | 350 | 300 | | | | |
| RSDP 18B/2/55.. | ⑨ 3250 | 55Hz | 0,37 | 64 | | 900 | 850 | 825 | 800 | 750 | 680 | 600 | 580 | 500 | 450 | 275 | | |
| RSDP 18B/2/60.. | ⑩ 3540 | 60Hz | 0,37 | 65 | | | 950 | 925 | 900 | 880 | 800 | 750 | 700 | 675 | 625 | 500 | 390 | |

(Direct Coupled) 1,3 and 8 operating points products without speed adjuster

(Direktantrieb) 1,3 und 8 Betriebspunkte Produkte ohne Drehzahlsteller